

# DS2

## STEEL 钢制传感器

S 型拉压式钢制传感器，应用于配料秤、工业称重系统

S-Type steel built load cell , tension and compression loading , used for batching scales , industrial weighing systems and force calibration systems

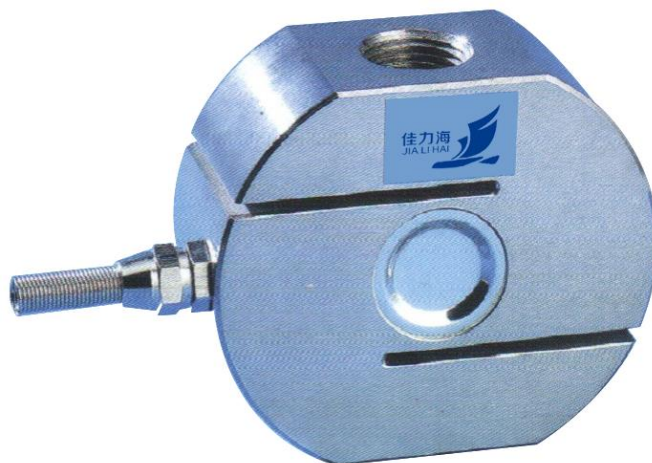

量程 CAPACITY ( kg )

50,100,200,300,1000,1500,2000,3000,5000,7500

外形尺寸 DIMENSIONS

外形尺寸 DIMENSIONS				
量程 Capacity(kg)	A	B	C	螺纹 M
50~500	63.5	22	59.5	M12
1000~2500	82	30	78	M16*2
3000~5000	102	45	90	M24*2
7500	167	50	163	M30*2

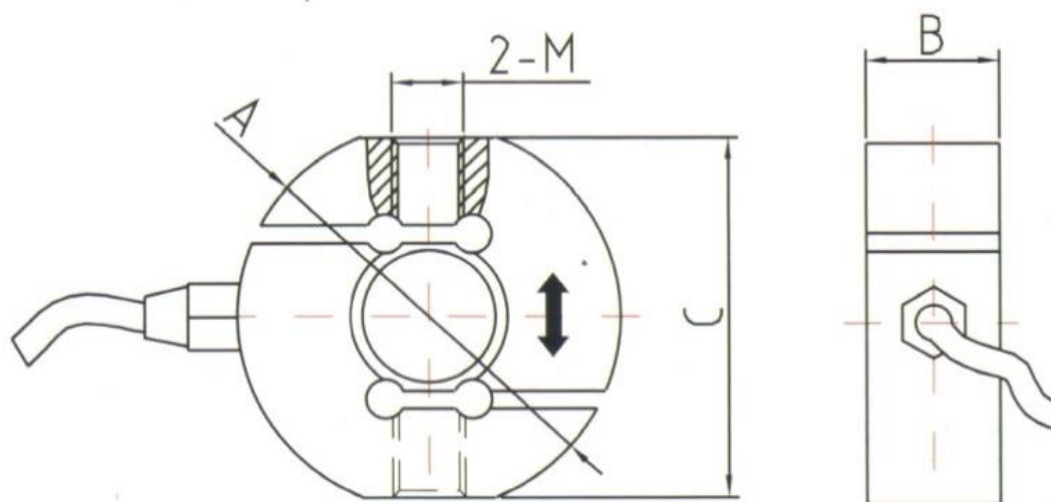

## 技术参数 SPECIFICATIONS

输出灵敏度	Rated Output	$2.0 \pm 10\% \text{mv/v}$
零点输出	Zero Balance	$\pm 2\% \text{F. S.}$
非线性	Non-linearity	$0.02\% \text{F. S.}$
滞后	Hysteresis	$0.02\% \text{F. S.}$
重复性	Non-Repeatability	$0.02\% \text{F. S.}$
蠕变(30分钟)	Creep(30min)	$0.025\% \text{F. S.}$
温度灵敏度漂移	Temp. Effect On Output	$0.025\% \text{F. S.} / 10^\circ \text{C}$
零点温度漂移	Temp. Effect On Zero	$0.025\% \text{F. S.} / 10^\circ \text{C}$
输入电阻	Input Impedance	$385 \pm 15 \Omega$
输出电阻	Output impedance	$350 \pm 3 \Omega$
绝缘电阻	Insulation	$> 2000 \text{M}\Omega / 50 \text{VDC}$
使用电压	Recommended Excitation	10V
最大使用电压	Maximum excitation	15V
温度补偿范围	Compensated Temp. Range	$-10 \sim 40^\circ \text{C}$
工作温度范围	Operating Temp. Range	$-20 \sim 60$
安全过载	Safe Overload	$150\% \text{F. S.}$
极限超载	Ultimate Overload	$300\% \text{F. S.}$
电缆线尺寸	Cable Size	$\Phi 5 \times 3000 \text{mm}$
防护等级	Protection Class	IP66
接线方式 Wiring <div style="display: flex; justify-content: center; gap: 20px; margin-top: 10px;"> <div style="display: flex; align-items: center;"> <span style="color: red; font-size: 1.2em; margin-right: 5px;">●</span> +输入 Excitation             </div> <div style="display: flex; align-items: center;"> <span style="color: black; font-size: 1.2em; margin-right: 5px;">●</span> -输入 Excitation             </div> <div style="display: flex; align-items: center;"> <span style="color: blue; font-size: 1.2em; margin-right: 5px;">●</span> +输出 Signal             </div> <div style="display: flex; align-items: center;"> <span style="color: orange; font-size: 1.2em; margin-right: 5px;">●</span> -输出 Signal             </div> </div>		